

NAME **Max Mächler**  
 COUNTRY **Germany**  
 RACE **ETS Rnd.1**  
 TRACK **ETS**

DATE **12-14.10.2012** TEMP.°C AIR / TRACK °C / °C

TRACK CONDITION TECHNICAL  MIXED  FAST   
 TRACTION LOW  MEDIUM  HIGH

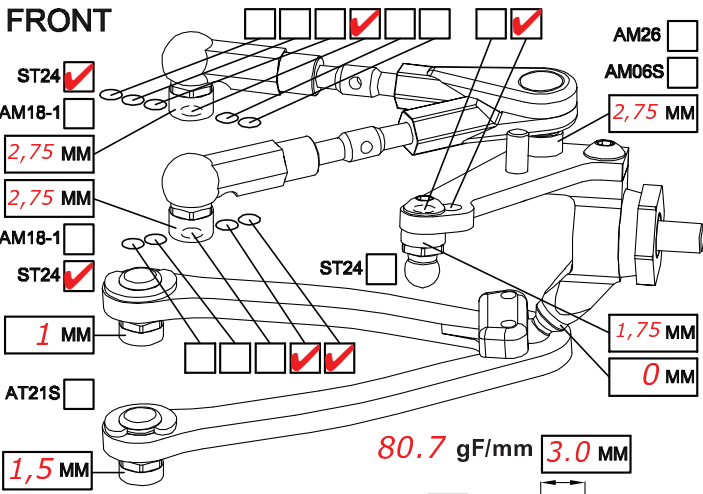

CAMBER ANGLE / ° **1,5°**  
 CASTER ANGLE / ° **6,75°**  
 TOE ANGLE / ° **1°**  
 RIDE HEIGHT / MM **5,4**  
 DOWNSTOP / MM **5,8**  
 UPSTOP / MM -

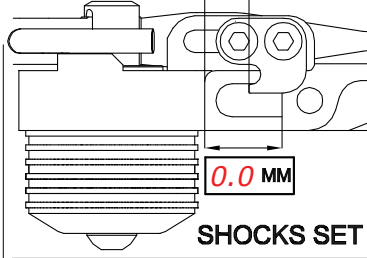

STABILIZER Ø / MM -  
 LOW ARM STD    
 STEERING ARM STD    
 WHEEL SPACER / MM -  
 FRONT DRIVE BALL DIFF  GEAR DIFF  SPOOL  ONE-WAY   
 DIFF SET LOOSE  MEDIUM  TIGHT  OIL  #  
 DOGBONE DRIVE BUSHING  C-DRIVE  BB  EVD

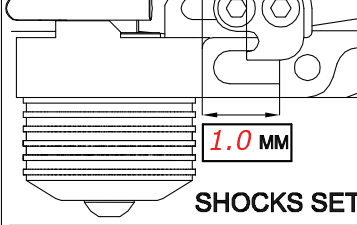
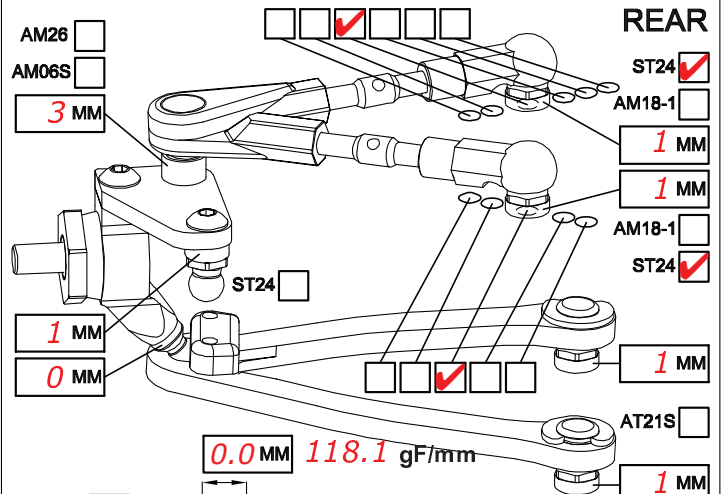

CAMBER ANGLE / ° **1,5°**  
 CASTER ANGLE / ° **4°**  
 TOE ANGLE / ° **3°**  
 RIDE HEIGHT / MM **5,4**  
 DOWNSTOP / MM **4,8**  
 UPSTOP / MM -

STABILIZER Ø / MM -  
 LOW ARM STD    
 STEERING ARM STD    
 WHEEL SPACER / MM -  
 REAR DRIVE BALL DIFF  GEAR DIFF   
 DIFF SET LOOSE  MEDIUM  TIGHT  OIL  # **MR33 B**  
 DOGBONE DRIVE BUSHING  C-DRIVE  BB  EVD

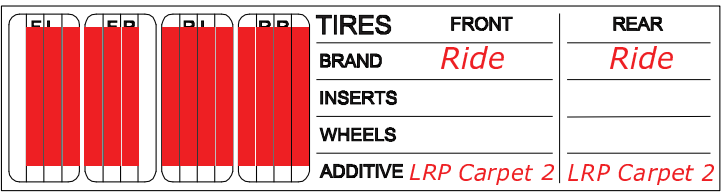
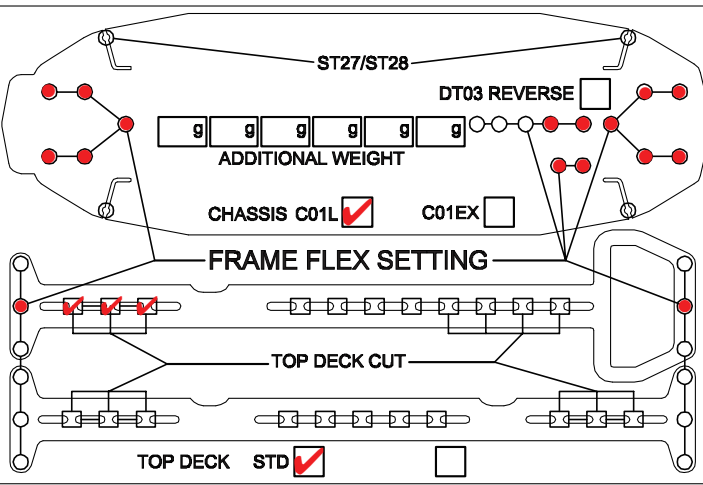

MOTOR LAYOUT LONG  TRANS  MOTOR **SP 3.0 13,5T**  
 SERVO LAYOUT LEFT  RIGHT  SERVO **Sanwa SDX 801**  
 ESC LAYOUT LEFT  RIGHT  ESC **Sp Cirtix**  
 BAT. LAYOUT R1  R2  F1  F2  BATTERY **Boomerang**  
 SPUR **87** PINION **40** RECEIVER **Futaba T3PK**  
 FINAL DRIVE RATIO **4,52** MOTOR OFFSET / MM -  
 BODY **PF Speed 6 lw** WING **MR33**

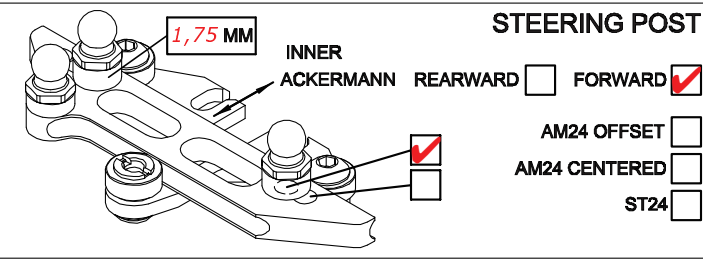

BEST LAPTIME QUALIF. / FINAL POSITION **9 / 5**  
 ESC SETTING  
 COMMENTS / IMPRESSIONS  
 CONTACT **Max.Maechler@gmx.de**